

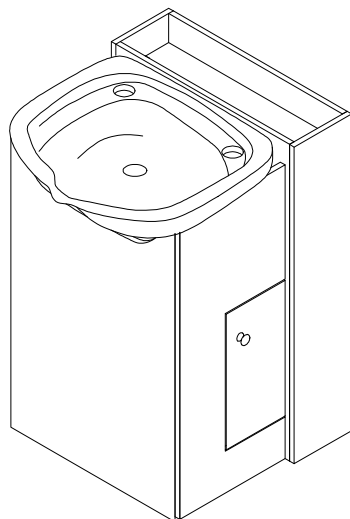

# Assembly Instructions

Callaway Shampoo  
Cabinet

Model # 5567



Callaway bowl (#5565) with mounting  
hardware sold separately

## Important Safety Instructions

- Please read all instructions carefully before assembling this desk.
- For your safety, assembly by two or more adults is strongly recommended.
- Keep these instructions for future use.
- Use only vendor supplied hardware to assemble this item. Using unauthorized hardware could jeopardize the structural integrity of the item.

## Pre-Assembly

- Remove all parts and hardware from the box. Place them on a carpeted or scratch-free work surface, as this will avoid damaging parts during assembly. The shipping box provides an ideal work surface.
- To avoid accidentally discarding small parts or hardware, do not dispose any packaging or contents of the shipping carton until assembly is complete.
- Use the parts and hardware list on the right to identify and separate all of the pieces included.
- The illustrations provided allow for easier assembly when used in conjunction with the assembly instructions.
- The use of power tools to aid in assembly is not recommended. Power tools can damage hardware and split wood.

## PARTS LIST\*

Part	Qty.	Description	Sketch
A	20	Cam screw and lock	
B	9	Wood dowel**	
C	1	Handle	
D	1	Handle screw	
E	14	Wood screw	
F	2	Hinge	
G	1	Metal door stop	
H	1	Bowl bracket (Included w/ bowl)	
I	6	Bracket screw (Included w/ bowl)	
J	1	Stabilizer bolt (Included w/ bowl)	
K	1	Stabilizer nut (Included w/ bowl)	

Phillips-head screwdriver required (+ drill recommended).  
\*Check inside all boxes for parts before beginning assembly.  
\*\*Dowels may already be attached to components.

## Components (Label - Description)

1 - Cabinet back  
2 - Cabinet front  
3 - Cabinet shelf  
4 - Cabinet left side  
5 - Cabinet right side

6 - Bowl shroud right side  
7 - Bowl shroud left side  
8 - Bowl shroud front  
9 - Door  
10 - Bowl (NOT included)

Using a  
cam lock

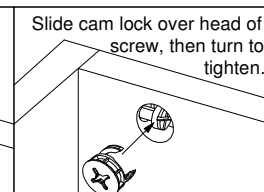
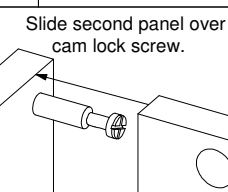
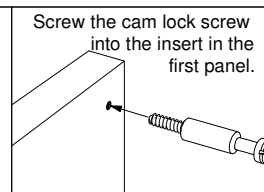



## 1 - Assembling the cabinet (1 of 2)

- 1) Screw 2 cam screws (A) and insert 1 dowel (B) into the top row of holes in the cabinet front (1) and back (2).
- 2) Insert the cam screws and dowels into the holes in the sides of the shelf (3), and secure with 4 cam locks (A).

Make sure the cam lock holes in the shelf are facing downward.

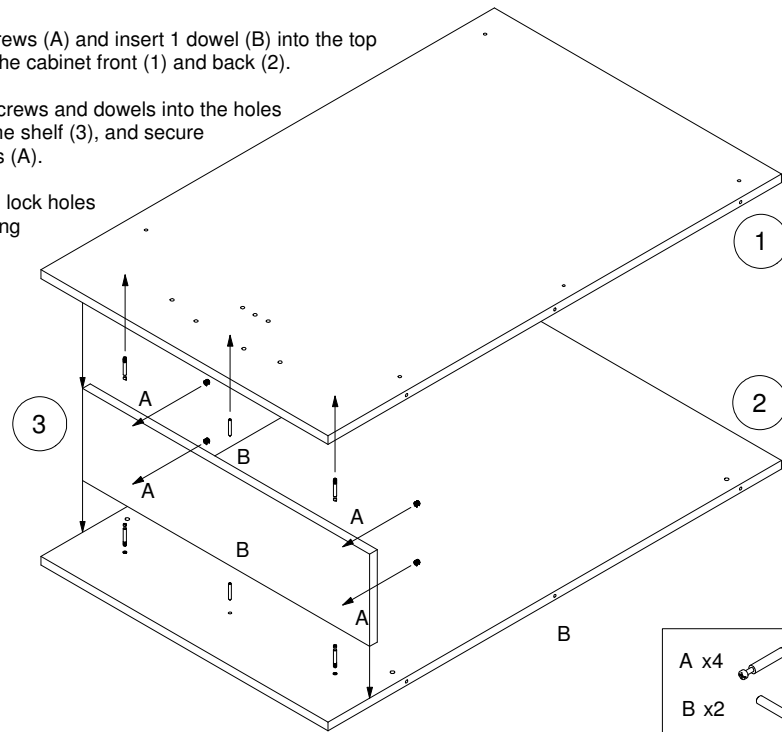

A x4  
B x2

## 2 - Assembling the cabinet (2 of 2)

- 1) Screw 4 cam screws (A) into the outermost holes in the right (4) and left (5) cabinet sides, and insert 2 dowels (B) into the center set of holes in each.
- 2) Slide the sides into the assembly from step 1, and secure the sides with 8 cam locks (A).

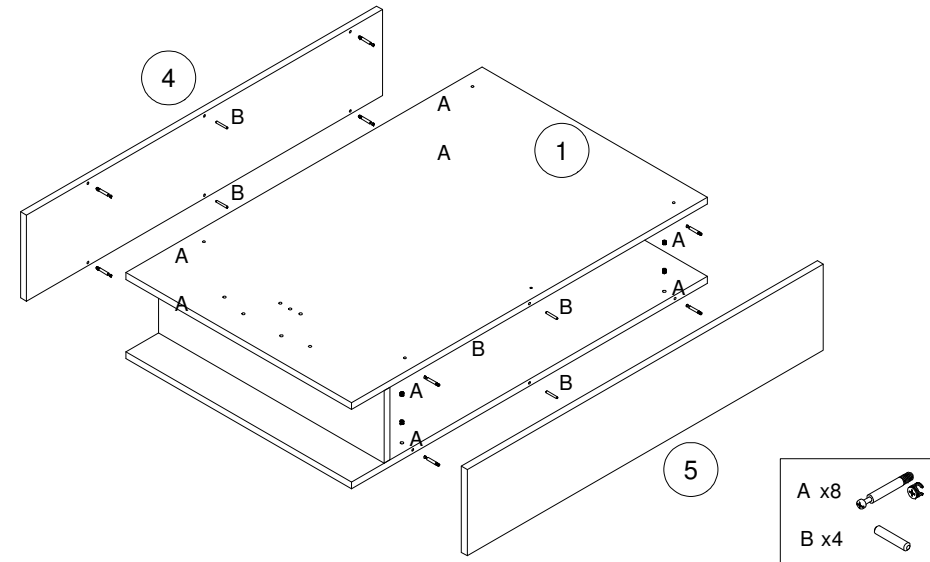

A x8  
B x4

## 3 - Mounting the door (1 of 2)

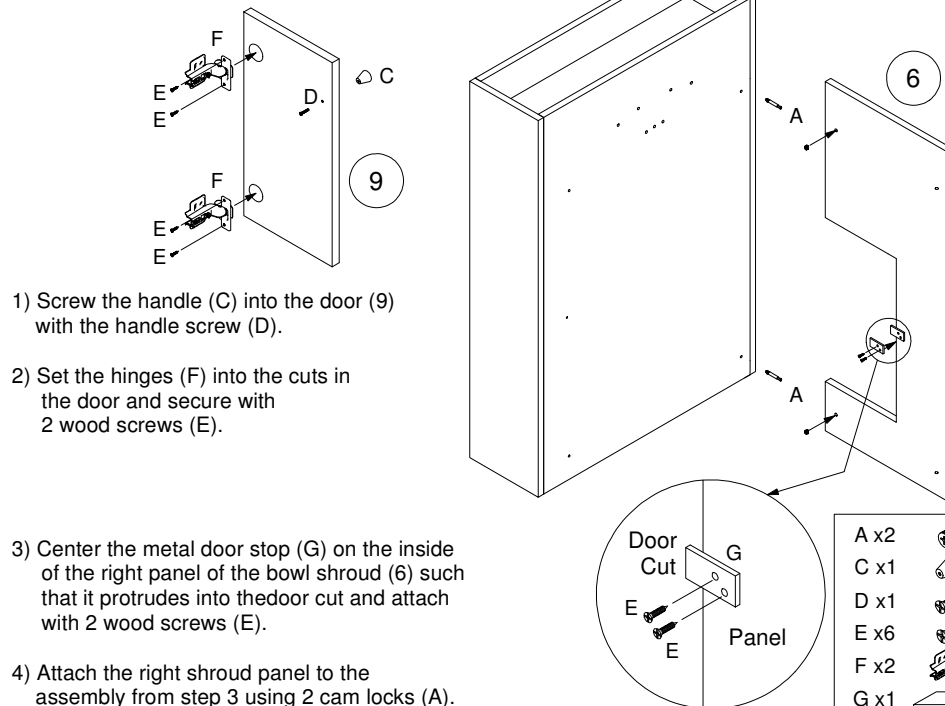

- 1) Screw the handle (C) into the door (9) with the handle screw (D).
- 2) Set the hinges (F) into the cuts in the door and secure with 2 wood screws (E).

- 3) Center the metal door stop (G) on the inside of the right panel of the bowl shroud (6) such that it protrudes into the door cut and attach with 2 wood screws (E).

- 4) Attach the right shroud panel to the assembly from step 3 using 2 cam locks (A).

A x2  
C x1  
D x1  
E x6  
F x2  
G x1

## 4 - Mounting the door (2 of 2)

- 1) With the hinges on the door in the closed positions as shown, set the door inside the cutout. Ensure corner of door is flush against the metal door stop and the hinges are flush with the cabinet. Use spacers (a coin, paper, etc, NOT included) to create an even gap at the top and bottom of the door.
- 2) Create a mark on the cabinet front inside the circular holes in the hinges.
- 3) Remove the door and hinges and drill screws halfway into the cabinet at the marked points, then back out.
- 4) Realign the hinges with the screw holes and re-secure the door to the cabinet using the new holes.
- 5) Gently check for proper opening and closing of the door, then secure with the remainder of the wood screws.

E x8

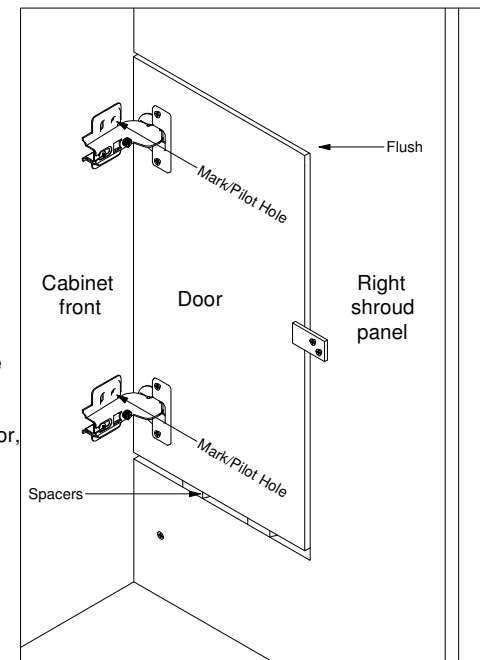



## 5 - Completing the bowl shroud (1 of 2)

- 1) Screw 2 cam screws and insert 1 dowel (B) into the cabinet front as shown.
- 2) Secure the left shroud panel (7) to the assembly from step 5 using 2 cam locks (A).

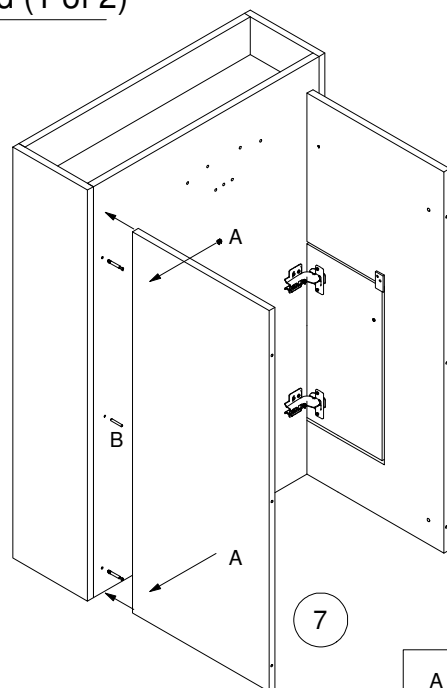

A x2  
B x1

## 6 - Completing the bowl shroud (2 of 2)

- 1) Screw 4 cam screws (A) and insert 2 dowels (B) into the front panel of the bowl shroud (8) as shown.
- 2) Secure the front panel to the assembly using 4 cam locks (A).

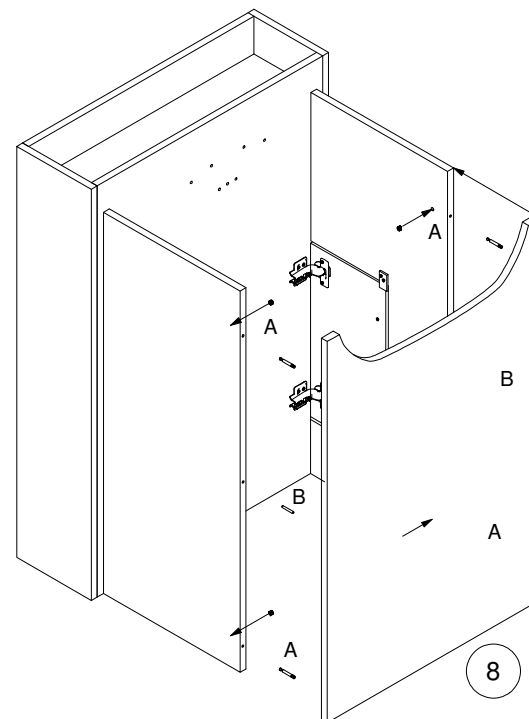

A x4  
B x2

## B1 - Installing the bowl hardware (Included in bowl purchase)

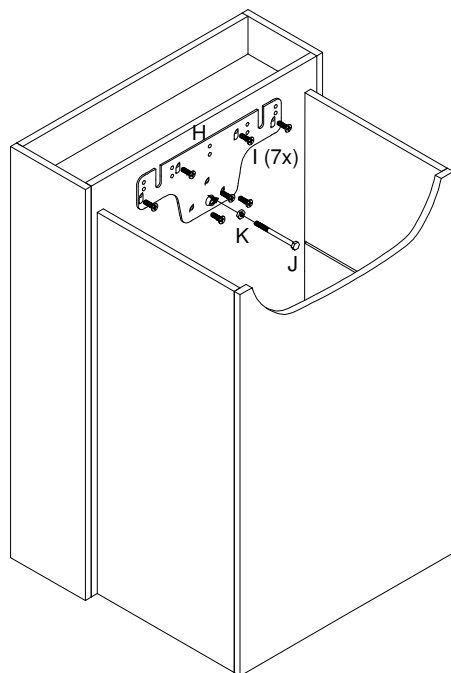

- 1) Orient the bracket such that there is space between the top of the bracket and the cabinet, and align the holes in the bracket with the inserts in the face of the cabinet.
- 2) Secure the bowl bracket (H) to the front face of the cabinet using 6 bracket screws (I) as shown.
- 3) Screw the stabilizer nut (K) onto the stabilizer bolt (J), then screw the bolt into the center of the 3 holes in the bottom of the bracket.

H x1  
I x7  
J x1  
K x1

## B2 - Installing the bowl

- 1) Slide the hook points on the back of the Callaway Shampoo Bowl (10) into the notches in the mounting bracket.
- 2) Through the access panel, adjust the stabilizer bolt so that the bolt head is close to but not touching the bowl (~1/8"), then hand-tighten the stabilizer nut to the bracket to lock the bolt in place.
- 3) Get a licensed plumber to make all necessary connections and test the unit. See the instructions included with the bowl for proper installation.

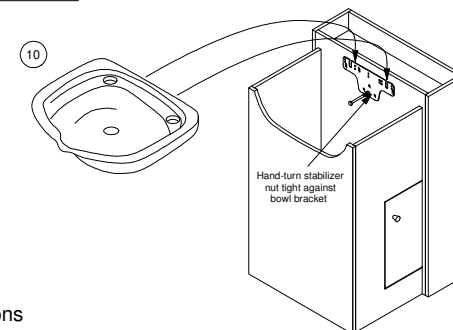

## Care Instructions

- Dust often using a clean, soft, dry and lint-free cloth.
- Blot spills immediately and wipe with a clean, damp cloth.
- We do not recommend the use of chemical cleansers, abrasives, or furniture polish on our lacquered finish.
- Hardware may loosen overtime. Periodically check to make sure all connections are tight. Re-tighten if necessary.